

# 3 Third Level

## LEGEND



Restrooms



Main Elevators



Clinic Elevators



ASU Elevator (P7)



Stairwells



Canteen Cafeteria / Retail  
Second Floor



Coffee Shop  
First Floor, Clinic Entrance



Vending  
First Floor, Fourth Floor



ATM  
First Floor, Main Lobby

1 Education

2 Simulation Lab

3 Dental Clinic

4 3 North Check-in  
Pain / Podiatry / Wound  
Pre-op Anesthesia

5 3 North

6 3 South / Oncology Clinic  
Hematology Clinic

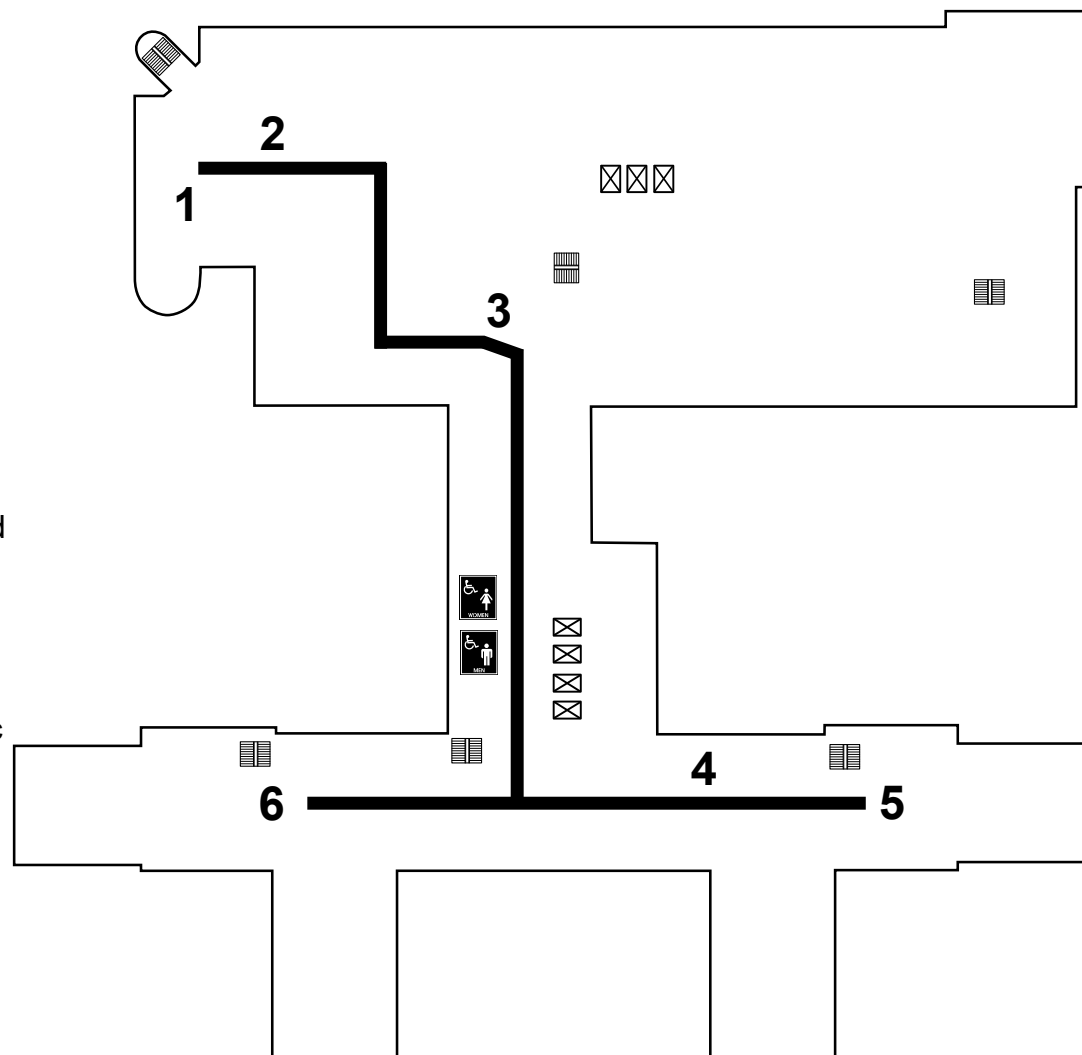

VA



**U.S. Department of Veterans Affairs**  
Veterans Health Administration  
Robley Rex VA Medical Center  
Louisville, Kentucky

800 Zorn Avenue  
502-287-4000  
[www.louisville.va.gov](http://www.louisville.va.gov)

Nov.. 2023